

UF-PSH-15

Art.-No.: 0510129

Abstract

Water filter module with 1.4 m² inner surface area.

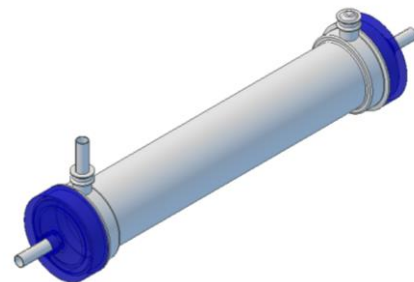
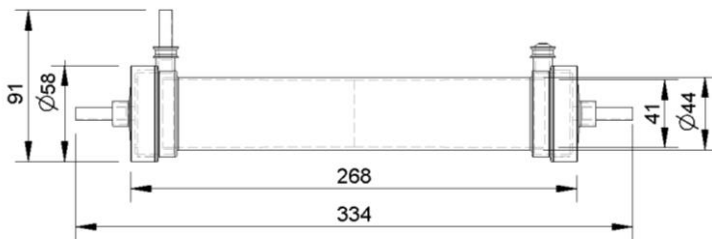

Membrane

| | |
|--------------------|--------------------|
| Membrane material: | PS-HF, Polysulfone |
| Geometry (ID/OD): | 200 µm/ 280 µm |
| MWCO / pore size: | 20 kDa |

Housing

| | |
|-------------------|--|
| Housing material: | Polycarbonate |
| Dimensions: | see drawing |
| ICS connectors: | 2 x Tube fitting OD = 8 mm (Polycarbonate) |
| ECS connector: | 1 x Tube fitting OD = 8 mm (Polycarbonate) |
| Potting material: | Polyurethane |

Module

| | |
|--------------------------|----------------------------|
| Number of fibers: | 9,216 ± 100 |
| Package density: | ~ 43 % |
| Active fiber length: | 242 ± 3 mm |
| Inner surface area: | 1.4 ± 0.03 m ² |
| Outer surface area: | 1.95 ± 0.04 m ² |
| Intra capillary volume: | ~ 76.7 ml |
| Extra capillary volume: | ~ 164.6 ml |
| Max. operating pressure: | 3 bar |

Miscellaneous

| | |
|-------------------------------|--|
| Quality control: | 100 % Integrity tested (housing + fiber) |
| Packaging: | On customer request |
| Gamma Irradiation (25-40kGy): | On customer request |

Cautions

| | |
|------------------------|------------------------|
| Storing: | dry, between 5 – 40 °C |
| Operating Temperature: | 5 – 40 °C |